

IMPORTANT!

The SPRINGBELT assembly should be installed to sound engineering practice by a competent fitter
 These instructions MUST be followed to ensure a safe fitment.
 Contact your SPRINGBELT supplier over any doubts on fitting details

INSTALLATION

1. Remove the existing belt and discard. Don't mix new with old.
2. Fit SPRINGBELT arm to the seat side opposite the side of entry. See Fig 1 per 3 – 5 below
3. Place the square spacer over the attach bolt, enter the attach bolt into the attach hole on RHS of seat and use the pointed dowel to mark a hole centre directly above the main attach hole. Centre punch and drill a 4.5. mm hole in the attach point. **IMPORTANT** - This hole must be on a Vertical line and directly above the attach hole or bolt so the square spacer is at 45 degrees.
4. Assemble the bush so the dowel engages in the 4.5 mm hole. Complete the assembly per Fig 2 and tighten attach bolt to 35 - 45 Nm. (Standard bush is 40 mm long but can be shortened if required. Min 12 mm)
5. Sit in the seat and adjust the SPRINGBELT arm up or down to lay comfortably across the hips. (Approximately 35 deg up from the horizontal) There is some articulation within the arm. Determine an average or mid position to allow for some adjustment while using. Tighten the 5/16 UNF bolt and nut on the locking plate. Fix the "click-on" plastic cover to enclose the bolt heads as shown ensuring the switch cable, if used, exits through the opening in the cover and is clear of bolts within the cover. Recheck the comfort.
6. Fit the Retractor unit or lap belt assembly to the entry side, adjust angle so the belt withdraws in alignment Tighten to 35 - 45 Nm
7. Check operation and ensure SPRINGBELT arm cannot be pushed down out of the way. Remove all tools.

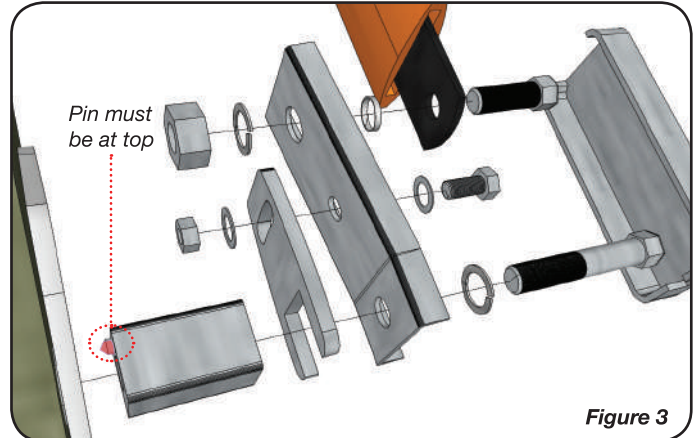
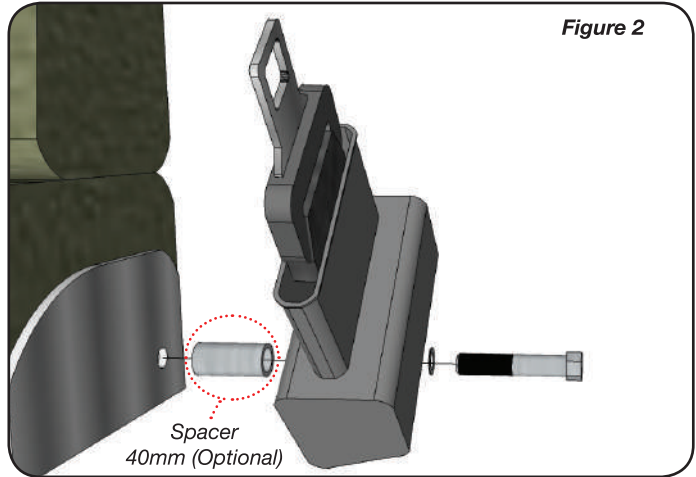
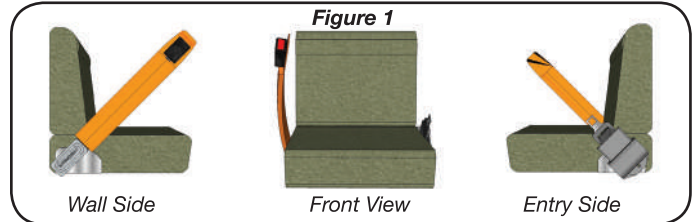
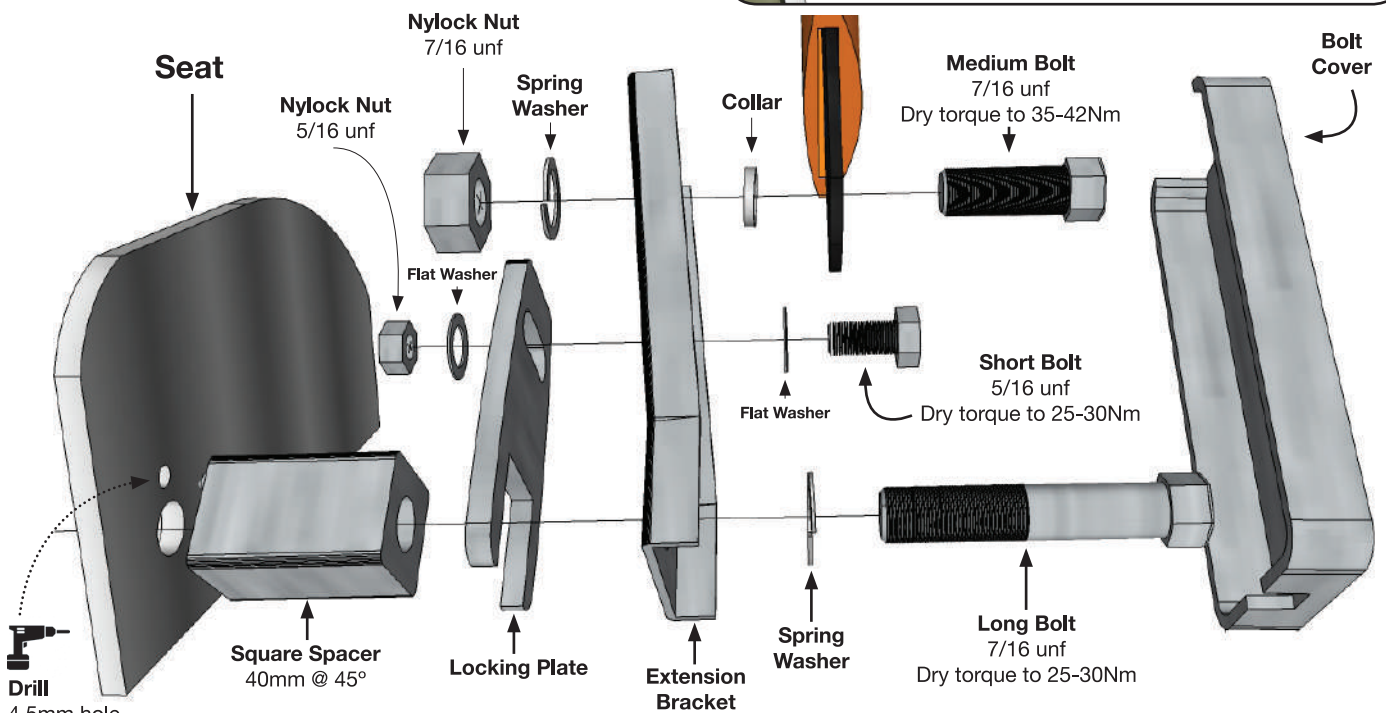

Figure 4



Manufactured by

INDUSTRIAL SEATBELTS LTD

Ph 0508 58 00 00 | 210 Antigua St. PO Box 28-058 Christchurch New Zealand